

No. 13415

Date: 3/15/00

Commonwealth of Massachusetts  
Sterling, Massachusetts  
***Soil Suitability Assessment for On-Site Sewage Disposal***

Performed By: Stephen Sears, Soil Evaluator

Date: 03/07/00

Witnessed By: Walter Irvine & Ernie Pitman

Location Address or Lot # 5 Main Street Sterling, MA 01564 New Construction <input checked="" type="checkbox"/> Repair <input type="checkbox"/>	Owner's Name, Address, and Telephone # Town of Sterling 5 Main Street Sterling, MA 01564 978-422-7331
--	---

**Office Review**

Published Soil Survey Available: No  Yes

Year Published 1985 Publication Scale 1"=20,000 Soil Map Unit 12

Drainage Class A Soil Limitations Severe:Poor Filter

Surficial Geologic Report Available: No  Yes

Year Published N/A Publication Scale N/A

Geologic Material (Map Unit) N/A

Landform N/A

Flood Insurance Rate Map: 250336 0009 B June 15,1982

Above 500 year flood boundary No  Yes

Within 500 year flood boundary No  Yes

Within 100 year flood boundary No  Yes

Wetland Area:

National Wetland Inventory Map (map unit) Upland

Wetlands Conservancy Program Map (map unit) N/A

Current Water Resource Conditions (USGS): Month February2000

Range: Above Normal  Normal  Below Normal

Other References Reviewed:USGS Sterling Quad Map/1985 Title5 map Panel14, 1995 Mass GISMay96

FORM 11 - SOIL EVALUATOR FORM

Location Address or Lot No. 5 Main Street Sterling, MA 01564

***On-site Review***

Deep Hole Number: 200-5 Date: 3/07/00 Time: 10:00 Weather: Cloudy, 50's

Location (identify on site plan) Across the street from the intersection of route #62 & #12 in Sterling center

Land Use Park Slope (%) 3-8% Surface Stones N/A

Vegetation Brush

Landform Outwash

Position on landscape (sketch on back) \_\_\_\_\_

Distances from:

Open Water Body N/A feet      Drainage way 75' feet  
 Possible Wet Area 300' feet      Property Line 15' feet  
 Drinking Water Well N/A feet      Other N/A

DEEP OBSERVATION HOLE LOG*					
Depth from Surface (Inches)	Soil Horizon	Soil Texture (USDA)	Soil Color (Munsell)	Soil Mottling	Other (Structure, Stones, Boulders, Consistency, % Gravel)
0-72"	FILL	N/A	N/A		N/A
72-120"	C	LS	10YR 2/2	36" 10YR5/8	Lose Single grain 30% gravel 10% stone, 10% cobble
Percolation profile					
0-16"	A				
16-24"	B	LS	10YR 3/2	N/A	N/A
36-64"	C	LS	10YR 2/2	36" 10YR 5/6	Friable, single grain, 10% gravel 10% stone 10% cobbles

\* MINIMUM OF 2 HOLES REQUIRED AT EVERY PROPOSED DISPOSAL AREA

Parent Material (geologic): Glacial outwash Depth to Bedrock: <120"

Depth to Groundwater: 36" Standing Water in Hole: 9' Weeping from pit face: 6'

Estimated Seasonal High Groundwater: 36"

Location Address or Lot No. #5 Main Street Sterling, MA

**Determination for Seasonal High Water Table**

Method Used:

- Depth observed standing in observation hole \_\_\_\_\_ inches
- Depth weeping from side of observation hole 72 inches
- Depth to soil mottles 36" inches
- Groundwater adjustment \_\_\_\_\_ feet

Index Well Number N/A Reading Date N/A Index well level N/A

Adjustment factor N/A Adjusted groundwater level N/A

Depth of Naturally Occurring Pervious Material

Does at least four feet of naturally occurring pervious material exist in all areas observed throughout the area proposed for the soil absorption system? yes

If not, what is the depth of naturally occurring pervious material? N/A

Certification

I certify that on 10/27/94 (date) I have passed the soil evaluator examination approved by the Department of Environmental Protection and that the above analysis was performed by me consistent with the required training, expertise and experience described in 310 CMR 15.017.

Signature  Date 03/15/00

Location Address or Lot No. #5 Main Street, Sterling, Ma

**Commonwealth of Massachusetts**  
**Sterling, Massachusetts**

<b>Percolation Test*</b>		
Date: 3/07/00		Time: 10:00
Observation Hole #	200-5	
Depth of Perc	64"	
Start Pre-soak	10:03	
End Pre-soak	10:18	
Time at 12"	10:18	
Time at 9"	10:22	
Time at 6"	10:29	
Time (9"-6")	7 Min.	
Rate Min. / Inch	3 min/inch	

\* Minimum of 1 percolation test must be performed in both the primary area AND reserve area.

Site Passed  Site Failed

Performed By: Stephen Sears, Soil Evaluator

Witnessed By: Walter Irvine & Ernie Pitman

Comments: \_\_\_\_\_

# WAUSHACUM

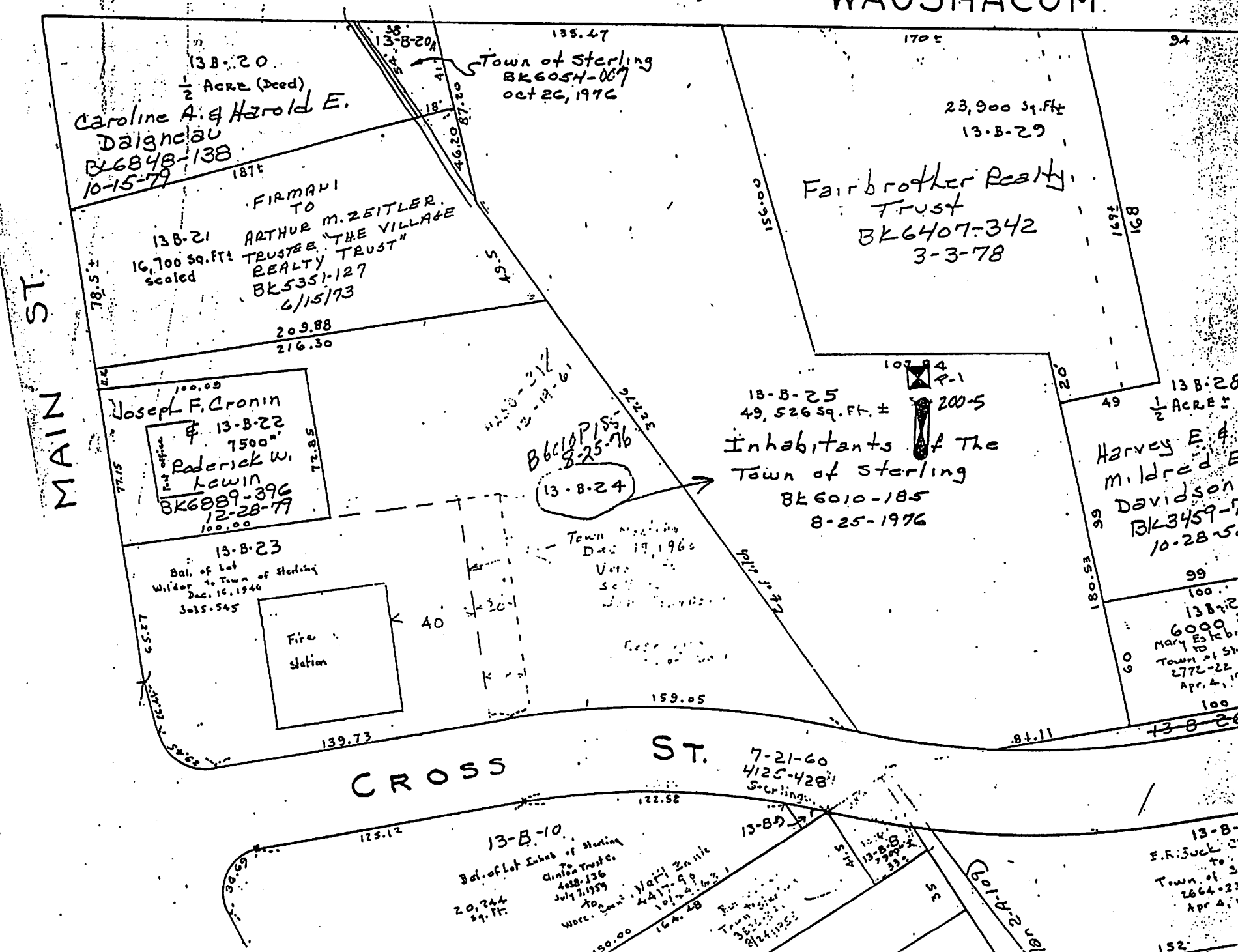

138-20  
 1/2 ACRE (Deed)  
 Caroline A. & Harold E. Daigneau  
 BK6848-138  
 10-15-79

Town of Sterling  
 BK6054-009  
 Oct 26, 1976

23,900 sq. ft.  
 13-B-29  
 Fairbrother Realty Trust  
 BK6407-342  
 3-3-78

FIRMAVI TO  
 ARTHUR M. ZEITLER  
 TRUSTEE "THE VILLAGE REALTY TRUST"  
 BK5351-127  
 6/15/73  
 16,700 sq. ft. scaled  
 209.88  
 216.30

Joseph F. Cronin &  
 13-B-22  
 7500 sq. ft.  
 Frederick W. Lewin  
 BK6089-396  
 12-28-79  
 100.00

13-B-25  
 49,526 sq. ft. ±  
 Inhabitants of The Town of Sterling  
 BK6010-185  
 8-25-1976

13-B-28  
 1/2 ACRE ±  
 Harvey E. & Mildred E. Davidson  
 BK3459-5  
 10-28-55

13-B-23  
 Bal. of Lot Wilder to Town of Sterling  
 Dec. 16, 1946  
 3035-545



13-B-24  
 BK610155-825-76  
 Town Meeting Dec 19, 1966

CROSS ST.  
 7-21-60  
 4125-4281  
 Sterling

13-B-10  
 Bal. of Lot Inhab. of Sterling  
 Clinton Trust Co.  
 4688-136  
 July 7, 1959  
 to  
 Wore. Court, North Zonia  
 4417-99  
 10-24-60

13-B-26  
 E.R. Suck  
 To  
 Town of S  
 2664-22  
 Apr 4, 1